

Turner is a triangular sling with two lifting straps at one side and a strap to fix on the bed frame at the other side.

The user lies on his back in the bed. Place the hand on the pointed end of Turner and push it under the patient's loin while pressing the sling a bit downwards.

Draw the fixing strap out at the other side of the patient and fix it to the bed frame.

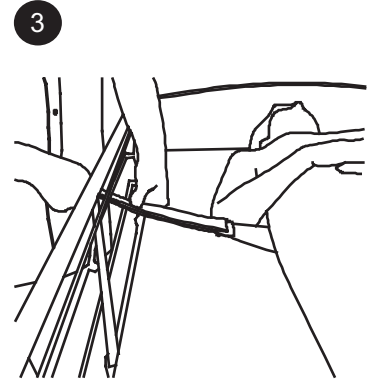
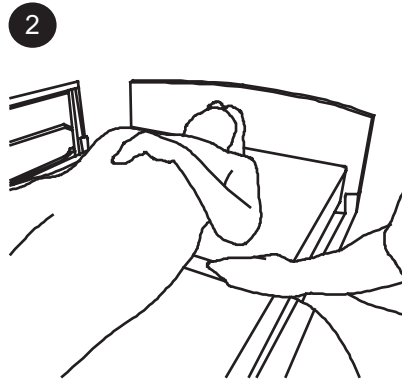
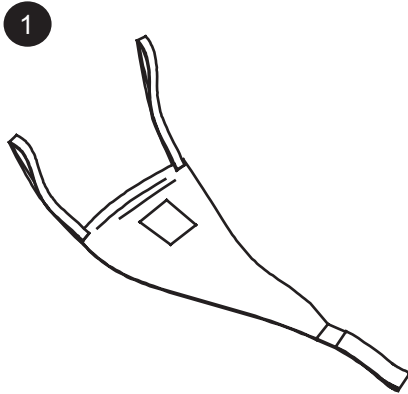

Now make the patient ready to be turned.

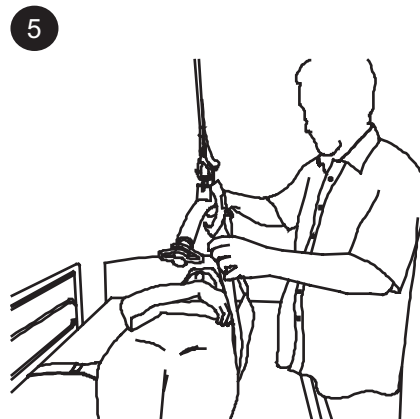

Mount the lifting straps on the lifting hanger of a ceiling hoist or a mobile hoist.

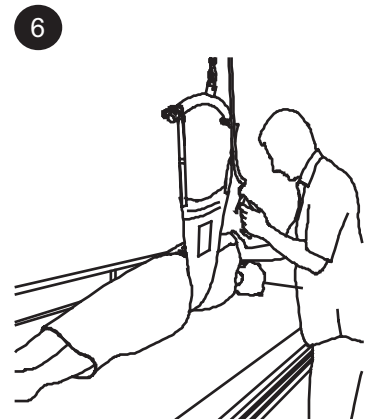

Activate the hoist and support the patient's shoulder at the same time. Never raise the lifting hanger higher than necessary.